

Specifications

Model	LR03	
Nominal Capacity ⁽¹⁾	1100 mAh	
Nominal Voltage	1.5 V	
Continuous Discharge at 20 Ohm ⁽²⁾	Initial	Ave. 17.3 hr
	After Storage ⁽³⁾	Ave. 17.0 hr
Temperature Range	-10 °C to +50 °C	
Weight	11 g	

(1) Nominal Capacity is determined to an end voltage of 0.9V when the battery is allowed to discharge at 20 Ohm at 20 °C.

(2) Discharge Condition : at 20 °C 65%RH, Cut off : 0.9V

(3) Storage condition : 3 years at 20 °C 65%RH

Dimensions

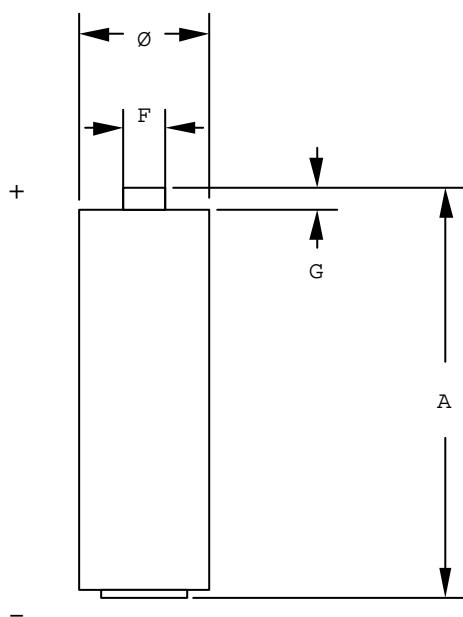

Sign	Dimension (mm)
Ø	9.5 – 10.5
A	43.3 – 44.5
F	2.0 – 3.8
G	Min 0.8