

DATA SHEET

NiCd BATTERY

DATA SHEET
Model No.:NC-AA800HT

Specification

Nominal Voltage		1.2V	
Capacity (mAh)	Rate	0.2C	0.5C
	Nominal	800	720
	Typical	850	800
Approx Weight		20g	
Internal Resistance(at 1KHz)		≦ 30mΩ	
Charge	Standard	0.1C ×15hrs	
	Trickle	0.03C -0.0625C	
Discharge cut-off voltage		1.0V	
Operation temp.	Standard charge	0 °C - 70 °C	
	Trickle charge	0 °C - 70 °C	
	Discharge	-20 °C - 70 °C	
Storage temp.	Within 6 month	-20 °C - 30 °C	
	Within a month	-20 °C - 40 °C	
	Within a week	-20 °C - 50 °C	
Relative humidity		65 ±20%	

Dimension

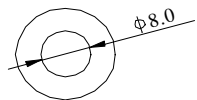
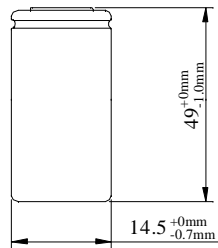

(with tube)

NOTE:

1. Nominal capacity rated at 0.2C
2. Other capacity are for reference
3. Weight and internal resistance are for reference

Typical characteristics

