

**MX 1400**  
**Size: C (LR14)**  
**Alkaline-Manganese Dioxide Battery**

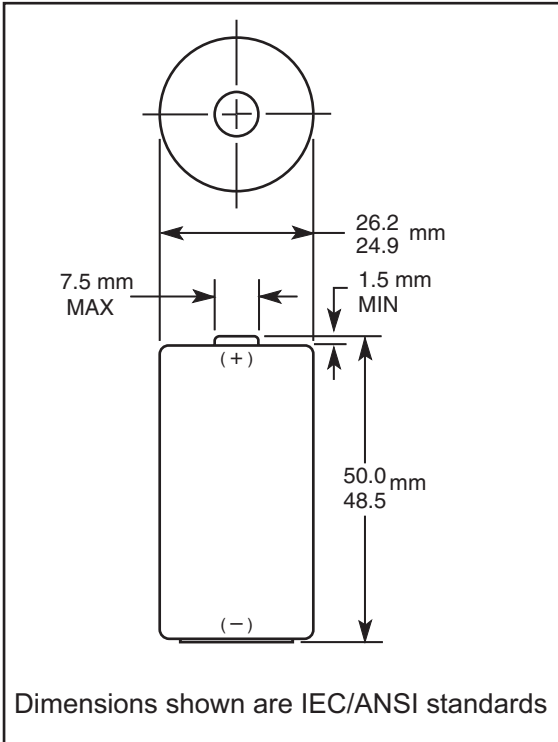

<b>Nominal Voltage:</b>	1.5 V
<b>Nominal Internal Impedance:</b>	130 m-ohm @ 1kHz
<b>Average Weight:</b>	71 gm (2.5 oz.)
<b>Volume:</b>	26.9 cm <sup>3</sup> (1.64 in. <sup>3</sup> )
<b>Terminals:</b>	Flat
<b>Operating Temperature Range:</b>	-20°C to 54°C (-4°F to 130°F)
<b>NEDA/ANSI:</b>	14A
<b>IEC:</b>	LR14

**TYPICAL DISCHARGE CHARACTERISTICS AT 21 °C (70°F)**

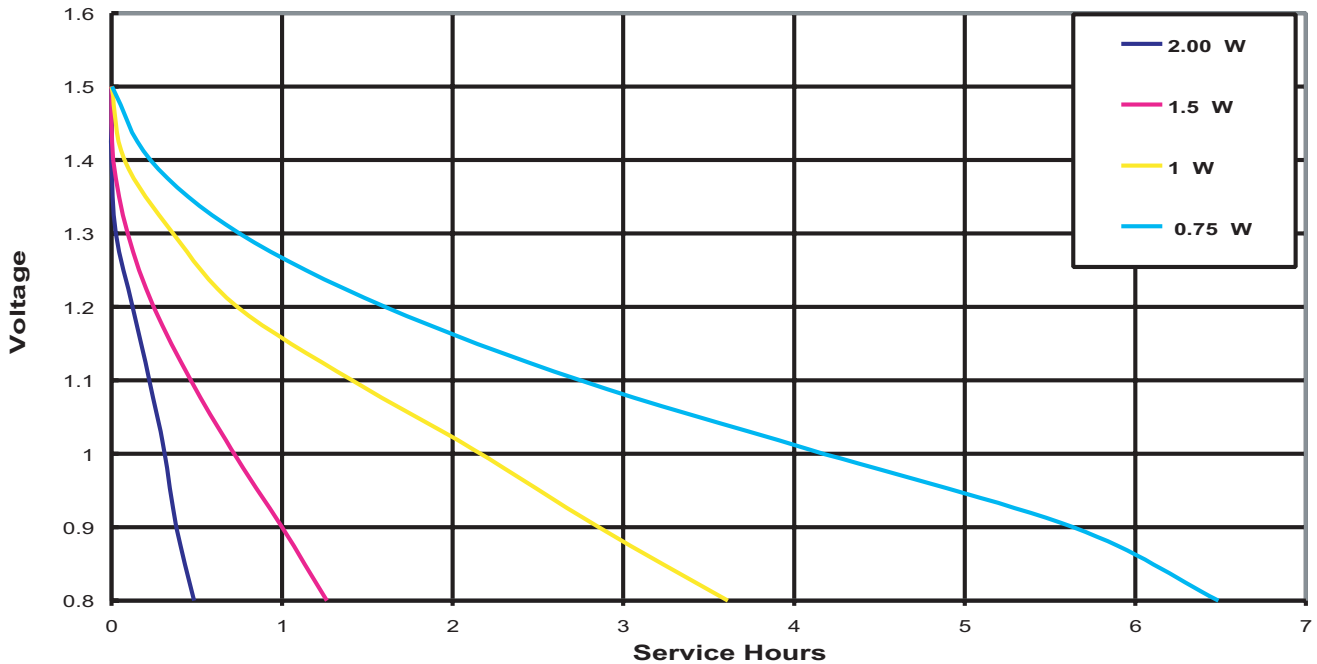

\* Delivered capacity is dependent on the applied load, operating temperature and cut-off voltage. Please refer to the charts and discharge data shown for examples of the energy / service life that the battery will provide for various load conditions.



# MX 1400

## Size: C (LR14)

### Alkaline-Manganese Dioxide Battery

Zn/MnO<sub>2</sub>

**Delivered Energy vs. Power Drain**

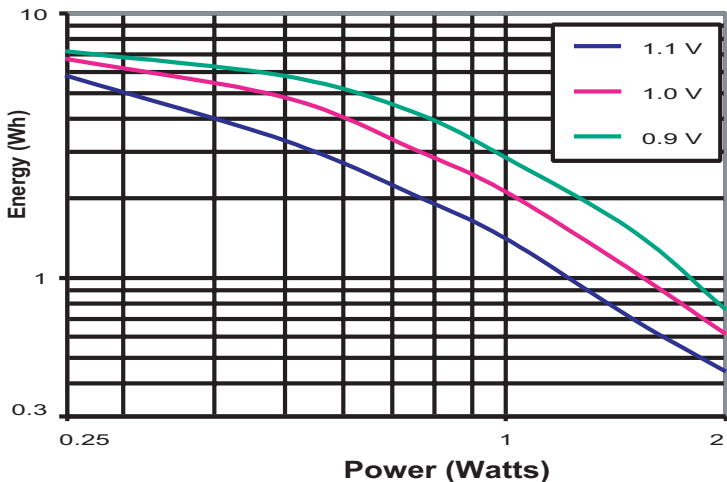

**Delivered Capacity vs. Power Drain**

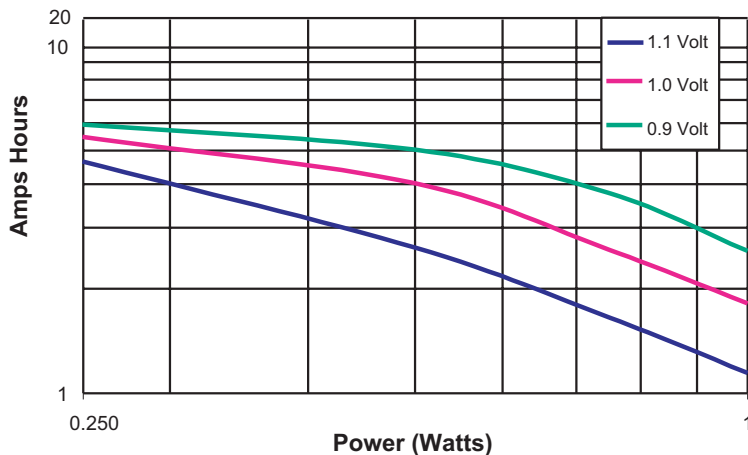

**Service Hours vs. Power Drain**

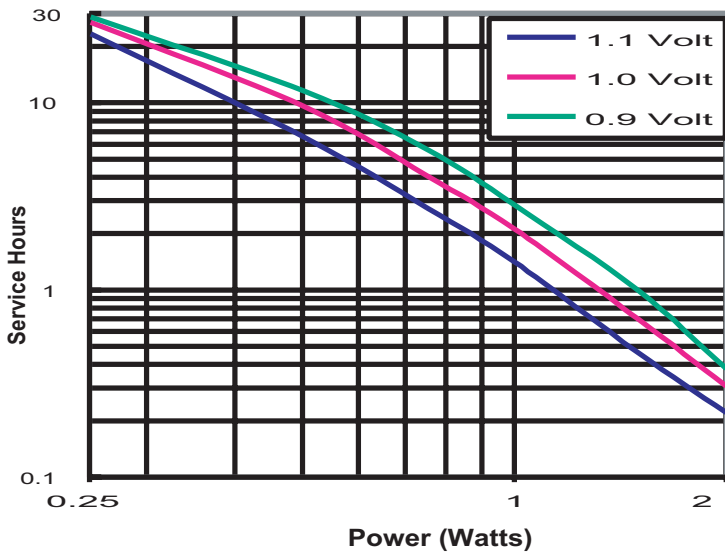

**DURACELL**<sup>®</sup>  
BATTERIES

Berkshire Corporate Park  
Bethel, CT 06801 U.S.A.  
Telephone: Toll-free 1-800-544-5454  
Internet: [www.duracell.com](http://www.duracell.com)

All testing at 21<sup>°</sup>C (70<sup>°</sup>F)

\* Delivered capacity is dependent on the applied load, operating temperature and cut-off voltage. Please refer to the charts and discharge data shown for examples of the energy / service life that the battery will provide for various load conditions.