

## Noark Inverter Wi-Fi Setup Quick Guide – Web

This is a quick guide to connect your solar system to myNoark energy management system via [Web](#). For smartphone setup, please refer to Quick Guide – App. Before reading the instructions, ensure Wi-Fi dongle is plugged into inverter and its power is on.

### Instructions

**Step 1:** Open Wi-Fi setting on your laptop or pad and connect “[USR-xxx-xxxx](#)” from the list. No password required.

\* This Wi-Fi has no internet connection, only used for Wi-Fi setup

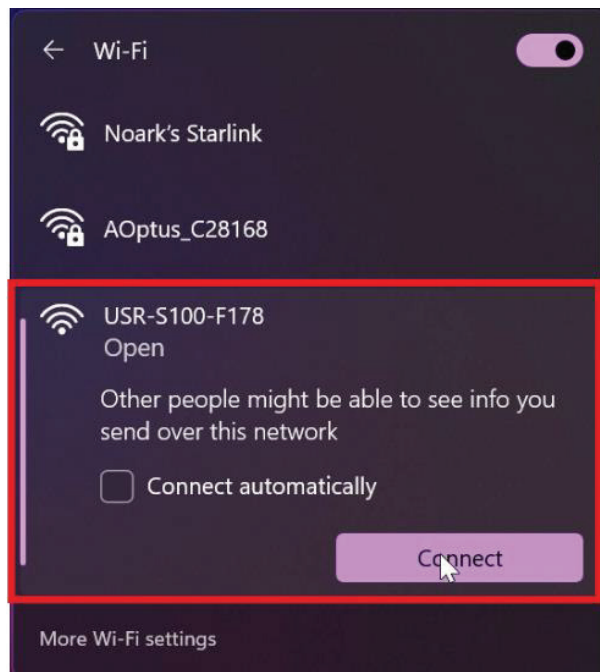

**Step 2:** Open any Browser and type [192.168.1.1](#) in the navigation bar.



**Step 3:** If sign-in is required, use the following details to login. If not, see the next step.



Username: admin

Password: chint1877global

Step 4: Select language as English.

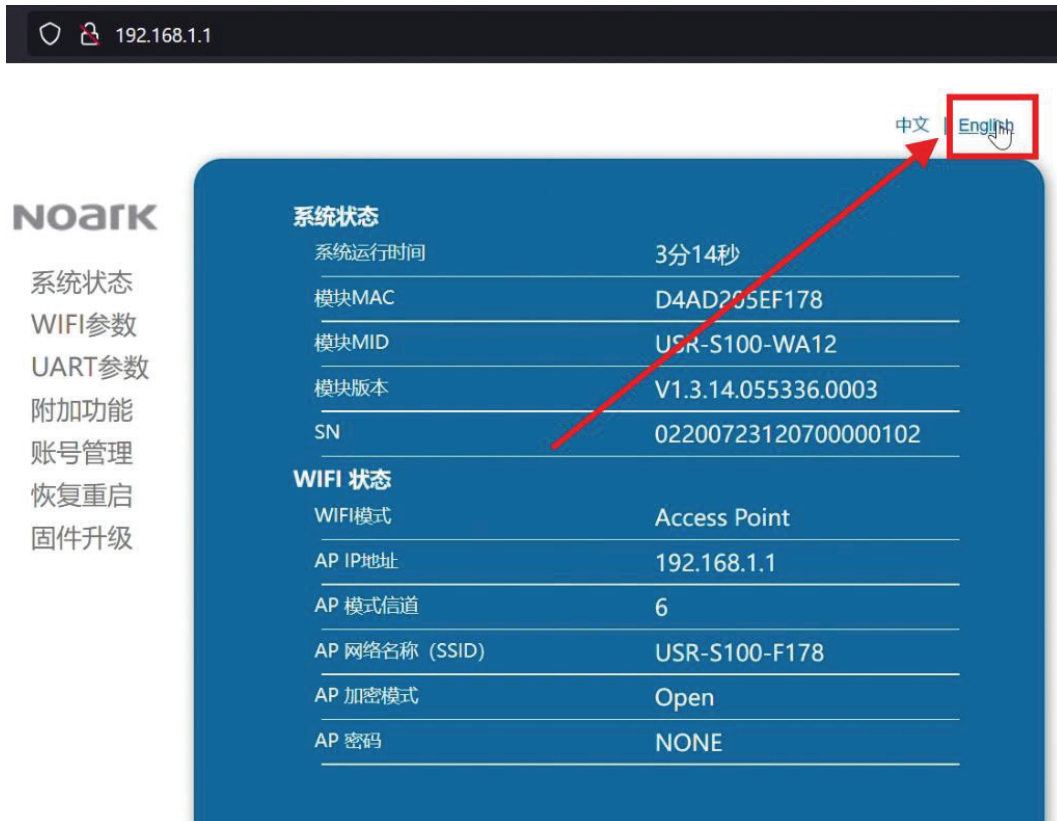

Step 5: Click WiFi Set from left sidebar. Then change Wifi Mode to APSTA and click Search.

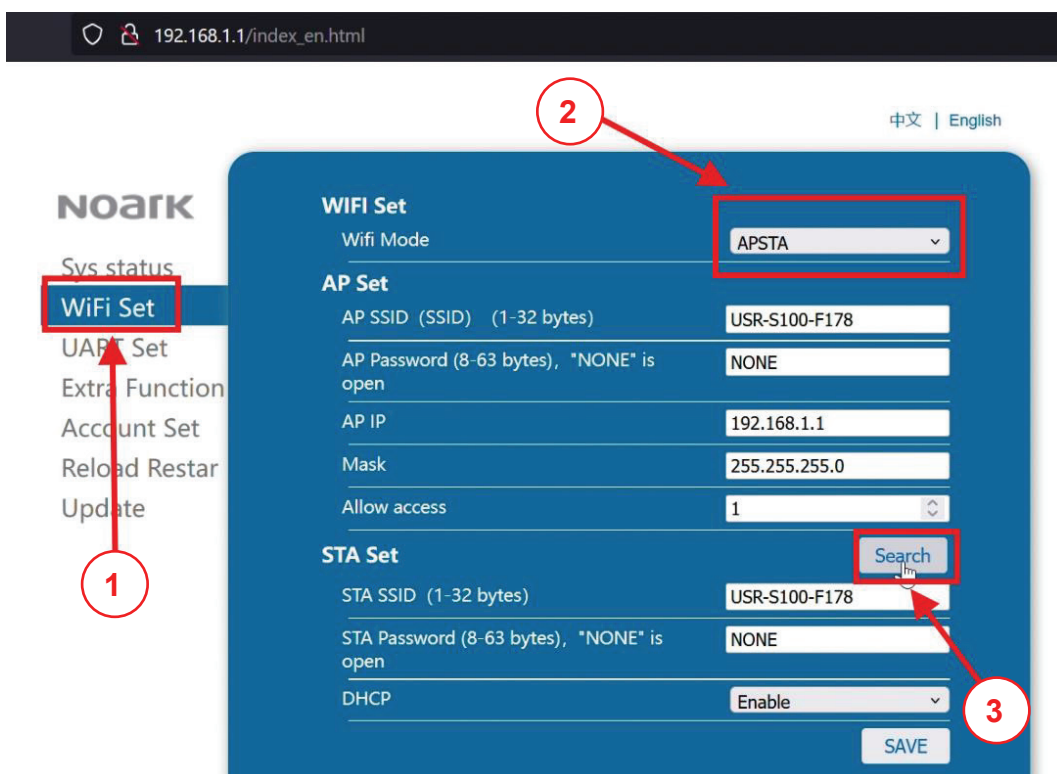

Step 6: Select your home or workplace Wi-Fi and click Save.

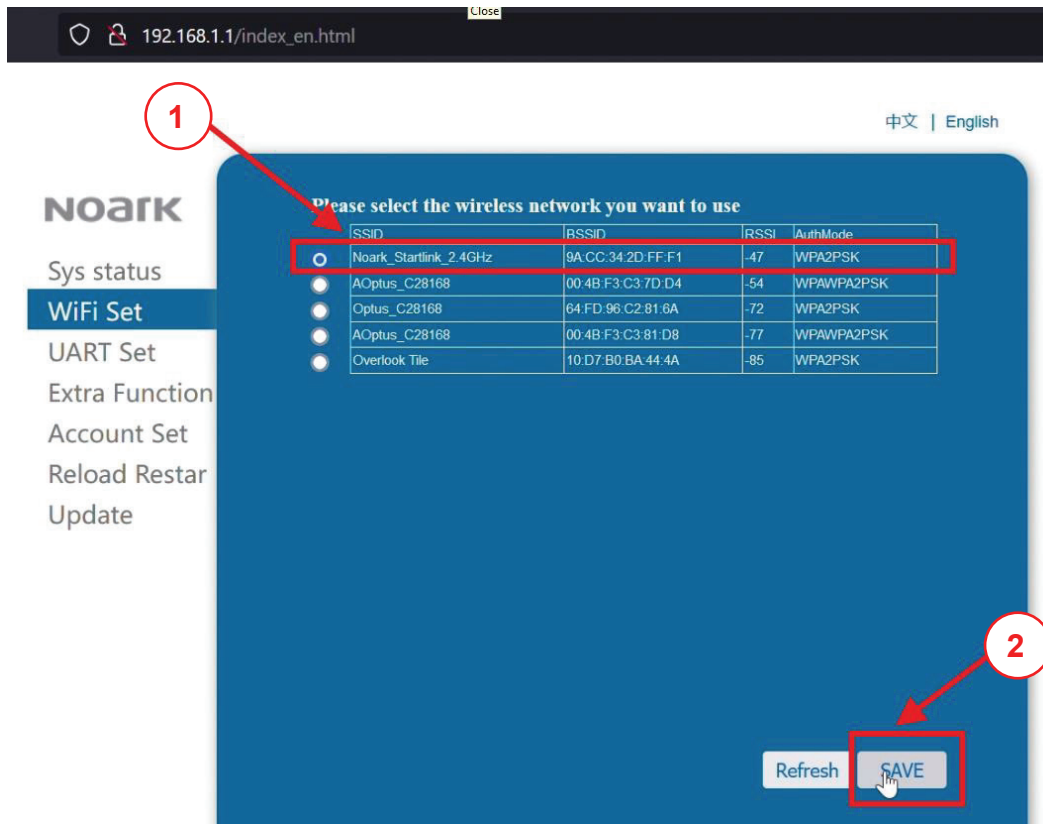

Step 7: Enter your Wi-Fi password and click Save.

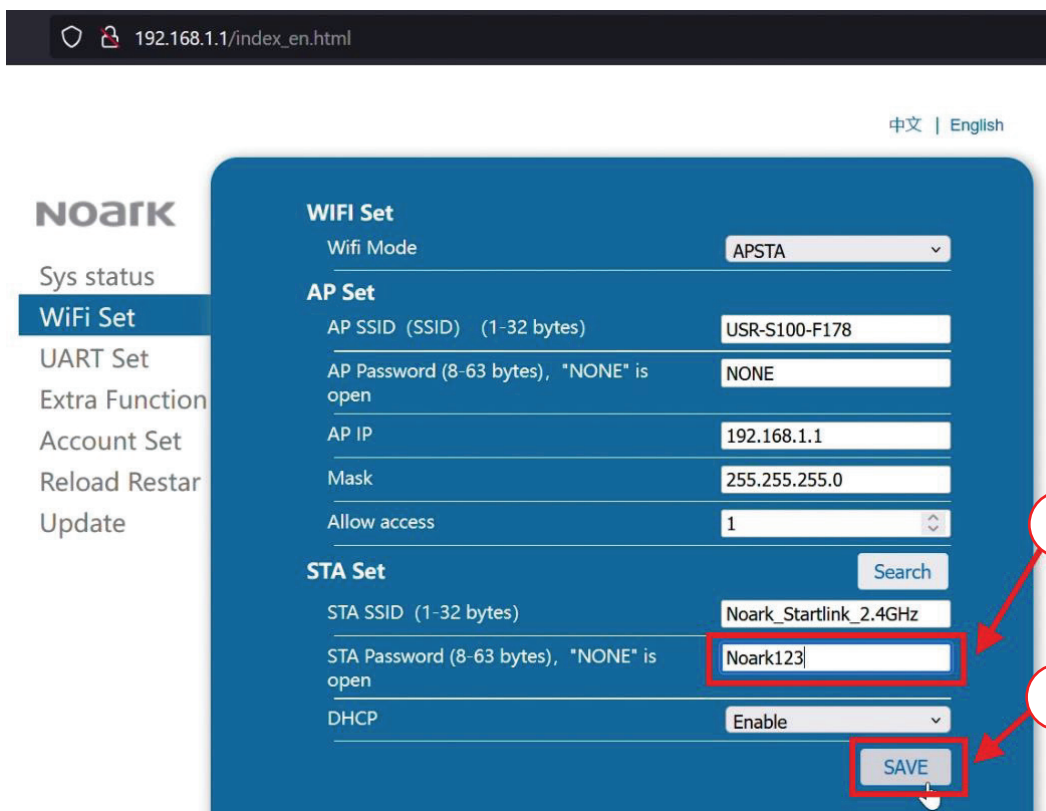

**Step 8:** Click **Restart**, then click **OK** to setup the Wi-Fi dongle.

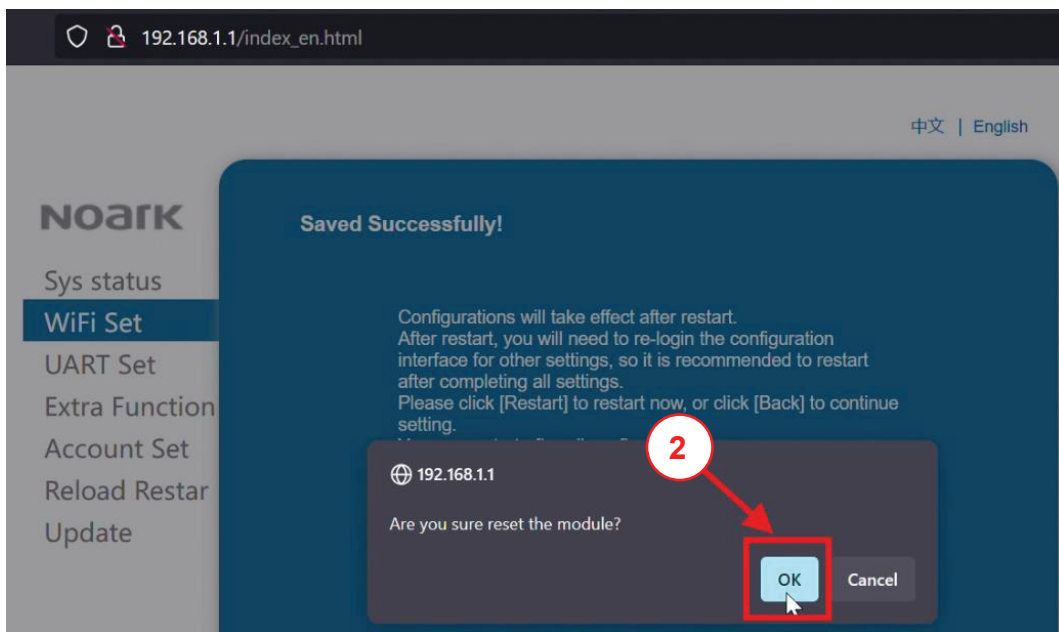
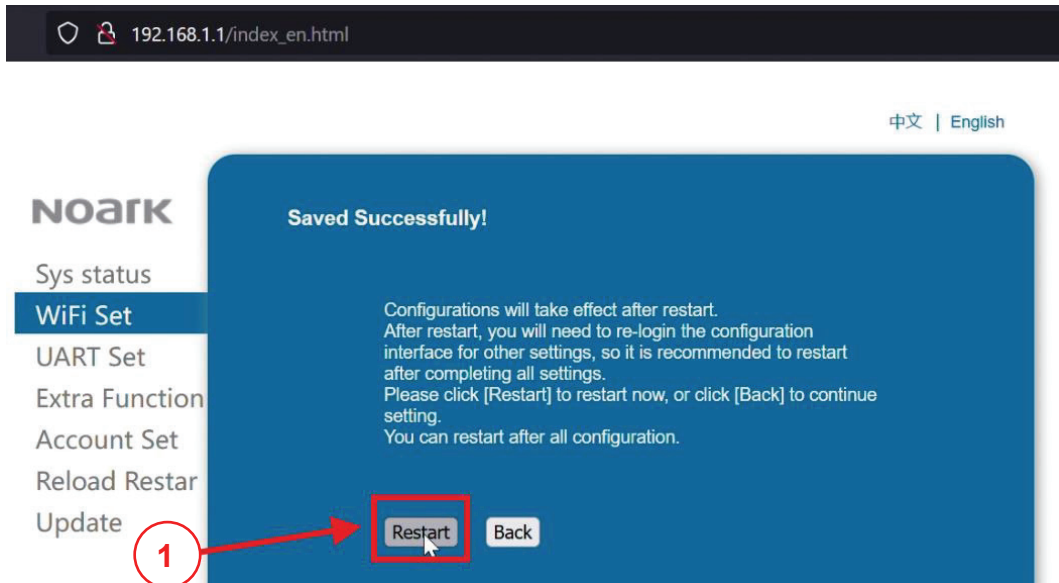

**Step 9:** When you see the following page, this means your Wi-Fi dongle is setup correctly. Now you can close the window.

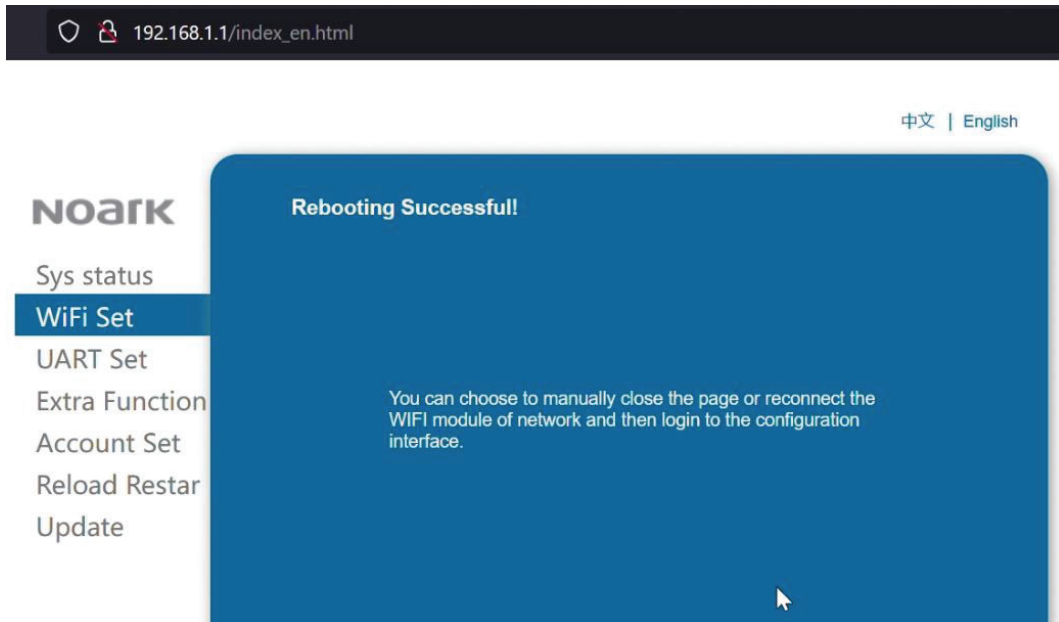

\*Wi-Fi dongle should have *green light on LINK* indicator and *red light on COM* indicator. The frequency is one flash per second.

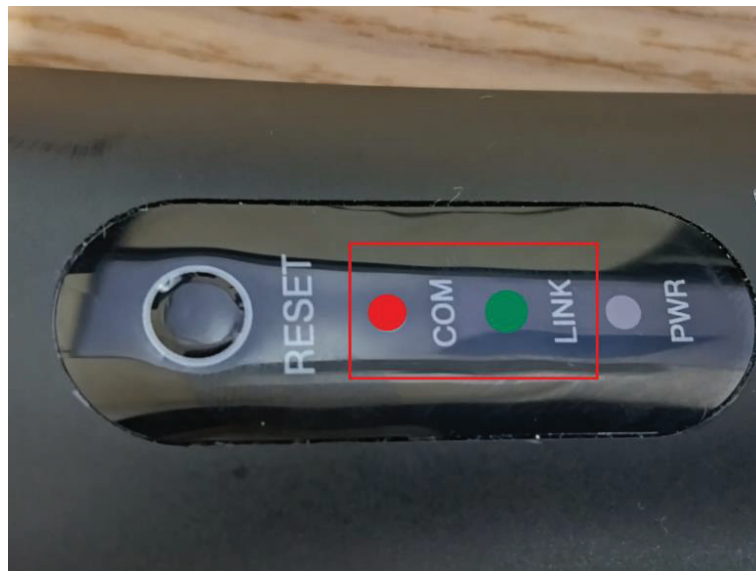

# NOARK

EMPOWERING SUSTAINABILITY

V1.102024



**Master Instruments Pty Ltd**

**NSW (Milperra):** (02) 9519 1200  
**WA (Wangara):** (08) 9302 5444  
**Web:** [www.master-instruments.com.au](http://www.master-instruments.com.au)

**VIC (Croydon South):** (03) 9872 6422  
**QLD (Eight Mile Plains):** (07) 3038 3250  
**Email:** [sales@master-instruments.com.au](mailto:sales@master-instruments.com.au)

Connect with us:

