

1



Battery safety warnings



- Please ensure the Drypower Lithium battery is installed in accordance with the manufacturer's guidelines and applicable Australian standards.
- Wear eye and clothing protection. Avoid touching eyes while working near batteries. Wash your hands when done.
- If battery acid contacts skin or clothing, wash them immediately with soap and water. If acid enters an eye, immediately flood the eye with running cold water for at least 15 minutes and get medical attention immediately.
- Be careful when using metal tools in the vicinity of batteries. Dropping a metal tool onto a battery might cause a short circuit.
- Remove personal metal items such as rings, bracelets, necklaces, and watches when working with a battery. A battery can produce a short circuit current high enough to melt objects such as rings, causing severe burns.

2

Introduction

- SmartShunt
- Two power cables
- The full manual is available online

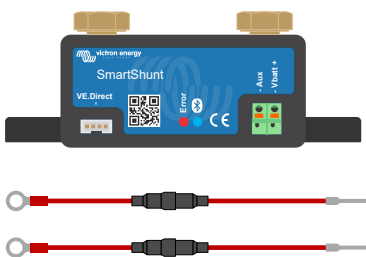

SmartShunt manual:



www.victronenergy.com.au/battery-monitors/smart-battery-shunt

3

Connect battery negative

- Connect the negative battery terminal to the SmartShunt BATTERY MINUS terminal.

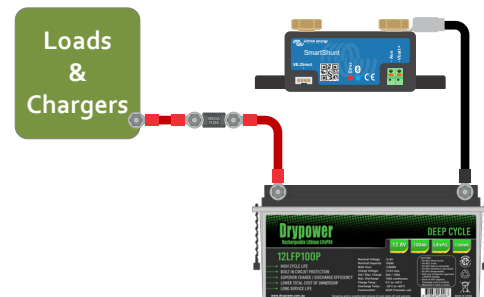

4

Connect DC load negative

- Connect the negative DC electrical system terminal to the SmartShunt SYSTEM MINUS terminal.

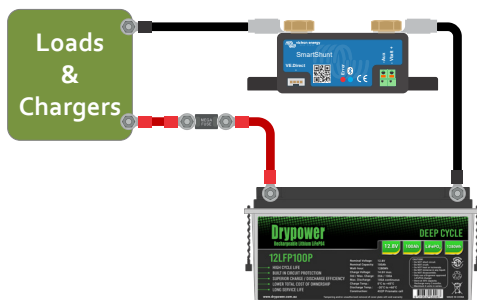

5

Connect power cable

- Connect the power cable between the positive battery terminal and the SmartShunt Vbatt+ terminal.

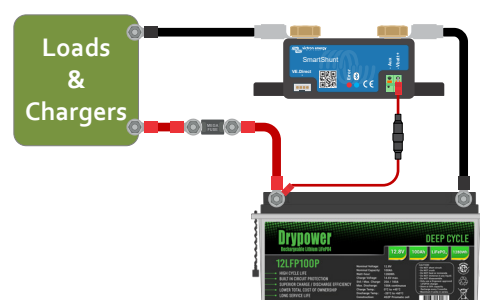

6

Programming via the VictronConnect App

- Download the VictronConnect app.
- Connect to the SmartShunt.

VictronConnect lets you get live status information and configure any Victron products which either have Bluetooth built-in, or are connected to a VE.Direct Bluetooth Smart Dongle.

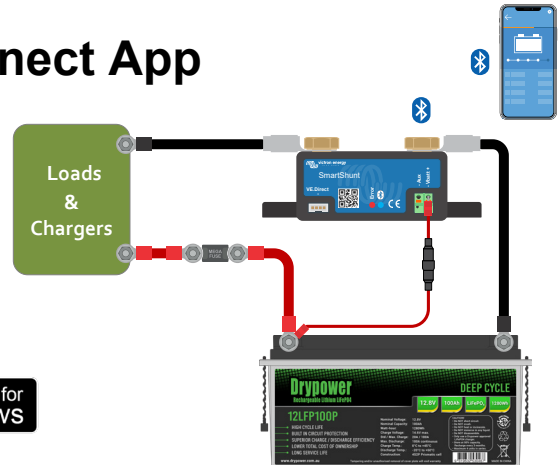

7

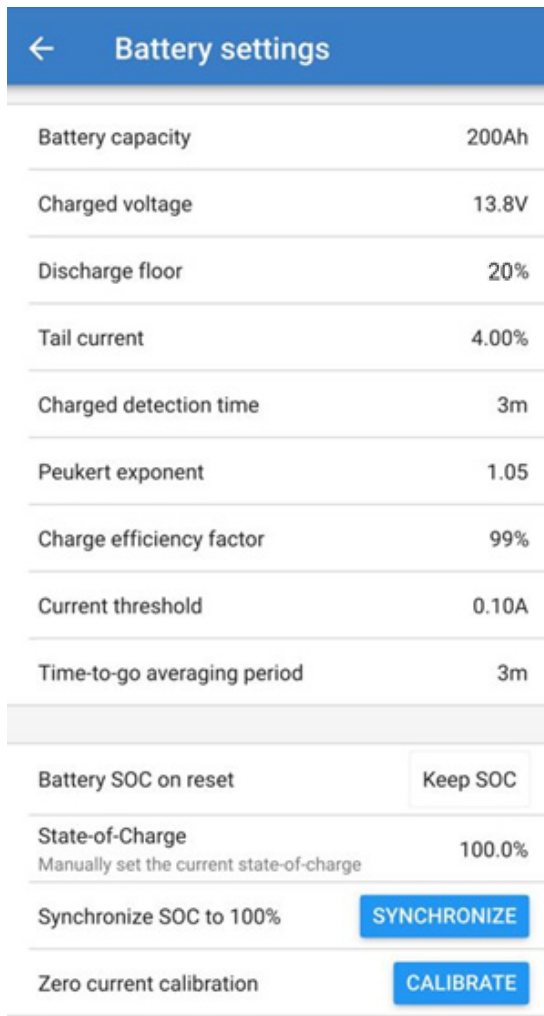

DRYPOWER STANDARD LiFePO4 SETTINGS

- ← Change this to the total capacity of the Drypower Lithium battery system.
- ← Change this to 13.8(0.4V below the Victron default Li-ion Charger Voltage).
- ← Change this to 20%. This setting is used in the "Time to go" calculation.
- ← Leave this as the default 4.00%.
- ← Leave this as the default 3 minutes.
- ← Change this to 1.05 as the preferred LiFePO4 setting.
- ← Change this to 99% as the preferred LiFePO4 setting.
- ← Leave this as the default 0.10A.
- ← Leave this as the default 3 minutes.
- ← Leave this as the default Keep SOC.
- ← Change this to 100%.

